

H.1 Site Plan
Scale: 1" = 50'-0"

OPENING SCHEDULE						
Mark	Dimensions	Description	Frame	Fire Rating	Hrdwr Set	Remarks
DOORS						
100	3'-8" x 7'-0" x 1 3/4"	Flush, Solid Core, Galvanized Hollow Metal	Hollow Mtl.			
101	3'-0" x 7'-0" x 1 3/4"	Aluminum, Narrow Stile, Storefront Type	Aluminum			
102	3'-0" x 6'-8" x 1 3/4"	Metal or Fiberglass French Door with Transom	Hollow Mtl.			
102	3'-0" x 7'-0" x 1 3/4"	Metal or Fiberglass French Door	Hollow Mtl.			
WINDOWS						
A	3'-8" x 5'-0"	Aluminum Storefront, Double Glazed	Aluminum			
B	22'-3" x 9'-0"	Aluminum Storefront, Double Glazed	Aluminum			
C	3'-8" x 5'-0"	Aluminum Clad, Fixed Double-Glazed Wood	Clad Wood			
D	6'-0" x 6'-0"	Aluminum Clad, Fixed Double-Glazed Wood	Clad Wood			
E	3'-0" x 5'-0"	Aluminum Clad, Single-Hung, Double-Glazed Wood	Clad Wood			1
REMARKS:						
1. Window on 2nd Floor level, RE: Elevations						

Building Information

- Foundation shall be post-tensioned type designed by a Louisiana licensed structural engineer. Building designer shall provide structural reactions to foundation designer for use in designing post-tensioned foundation.
- Provide block outs in slab for future plumbing as required. Coordinate locations with Owner prior to design of foundation.
- Building shell shall be pre-engineered structure with lap seam metal roof at 1:12 and metal wall panels on North and West sides. Building designer shall provide structural reactions to foundation designer for use in designing post-tensioned foundation.
- Exterior walls on South, East and part of West sides shall be cold-formed metal framing, sized by the manufacturer's or other Louisiana licensed structural engineer. Finish shall be cement plaster over fiberglass faced gypsum sheathing, except as noted otherwise.
- Provide 1/4" R-10 foil faced radiant barrier at underside of metal roofing and behind wall panels or finish. Final insulating work at each suite shall be provided for each tenant build-out.
- Mechanical and plumbing work at each suite shall be provided for each tenant build-out.
- Electrical service and meter at each suite shall be provided for each tenant build-out.

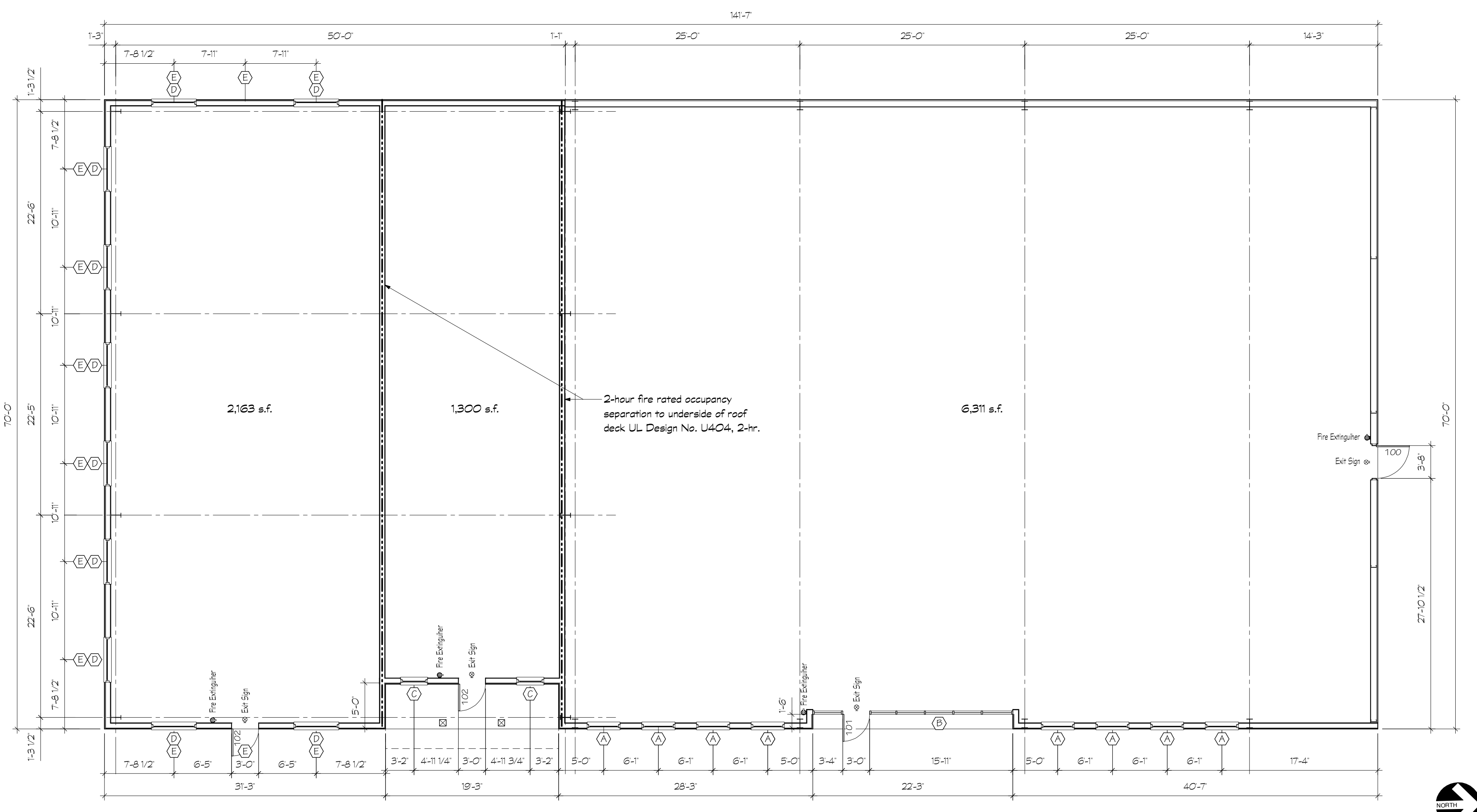

A.6 Floor Plan
Scale: 1/8" = 1'-0"

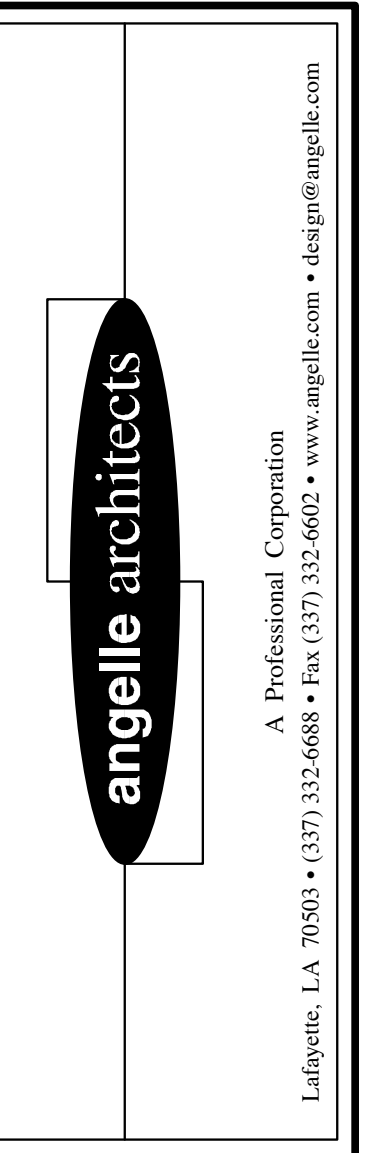

Building 805 - Building Shell
Broussard Commons
Broussard, Louisiana



REVISIONS

DATE	DESCRIPTION

Project No. 20603.00
Drawn By DAL
Checked By GEA
Date 5 June 2006
Scale As Indicated
Drawing Title
Floor & Site Plans
Drawing No.

A.100
1 Of 3 Sheets